

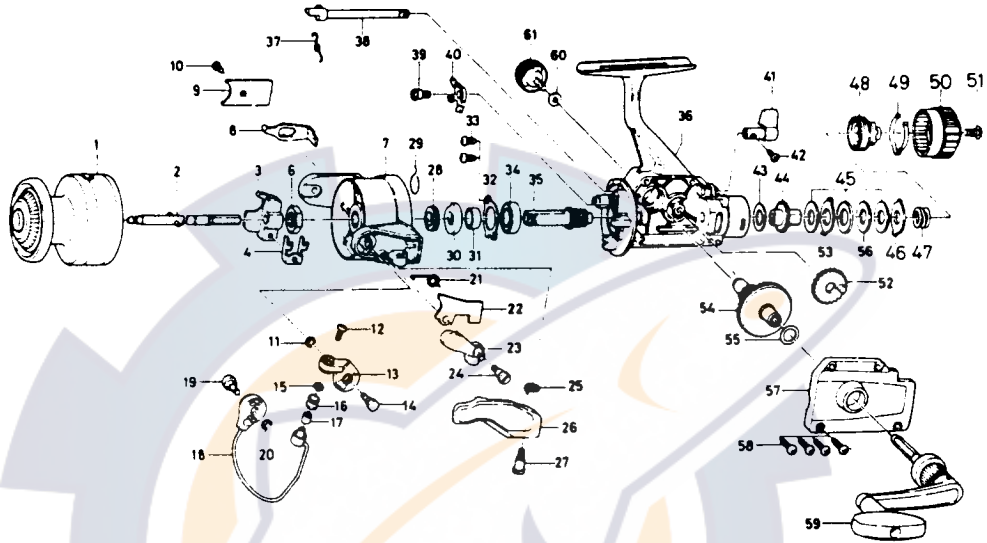

SPINNING REEL **AG1655B/2055B**



Key No.	Parts No.	Parts Name	Key No.	Parts No.	Parts Name
1	K10-8502	Spool	37	144-0321	Anti-reverse cam spring
2	B83-9801	Main shaft	38	B83-6001	Anti-reverse cam
3	E08-7801	Oscillating slider	39	K03-2901	Anti-reverse pawl screw
4	B93-7202	Oscillating slider retainer	40	K02-3301	Anti-reverse pawl
6	B10-5701	Rotor nut	41	E08-6101	Anti-reverse lever
7	B82-1901	Rotor	42	B12-8201	Anti-reverse lever screw
8	B83-6701	Bail trip lever	43	B46-9505	Drag washer A
9	B76-9701	Bail trip cover	44	B76-9803	Click gear
10	B83-4402	Bail trip cover screw	45	E14-3301	Drag washer B
11	320-5901	Bail arm screw retainer	46	B83-9501	Eared washer A
12	B67-9302	Line roller screw	47	K02-6701	Drag coil spring
13	B67-4601	Bail arm	48	B77-0004	Drag screw
14	B83-3801	Bail arm screw	49	B77-0301	Drag washer spring
15	B55-4301	Line roller washer A	50	K05-0201	Drag knob
16	250-3921	Line roller	51	352-1107	Drag knob spring screw
17	B45-1501	Line roller bushing	52	B74-3701	Oscillating gear
18	K10-7702	Bail	53	K05-0301	Eared washer B
19	B83-4202	Bail trip cam screw	54	K10-5601	Drive gear
20	320-5901	Bail trip cam screw retainer	55	373-7800	Drive gear washer
21	K04-9901	Bail spring	56	E02-4401	key washer
22	B83-6402	Bail spring cover	57	K04-9401	Side cover
23	B76-9301	Trigger plate	58	B83-5002	Side cover screw
24	K03-7302	Bail spring cover screw	59	E00-2502	Handle
25	B67-5201	Trigger spring	60	B92-4902	Handle lock washer
26	B67-5105	Trigger lever	61	B92-5001	Handle lock screw
27	K03-7302	Trigger screw			
28	B68-6401	Spring holder			
29	145-0902	Anti-reverse pawl spring			
30	B67-4301	Anti-reverse ratchet			
31	K03-1701	Spacing sleeve			
32	B35-6301	Bearing retainer			
33	B83-4402	Bearing retainer screw			
34	B54-6001	Ball bearing			
35	K10-5502	Pinion gear			
36	K04-9101	Body			

AG2055B Special Parts		
1	K10-8602	Spool
7	B82-2101	Rotor
8	B83-7301	Bail trip lever
18	K10-7902	Bail
36	K04-9103	Body
57	K04-9404	Side cover
59	E00-2802	Handle